

RoHS compliant

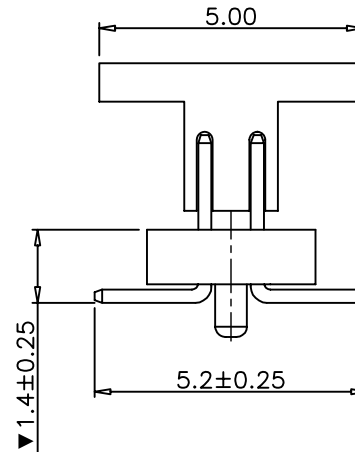

Recommended PCB Layout

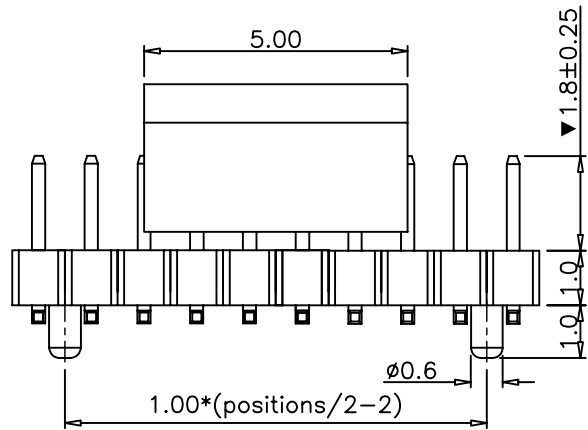
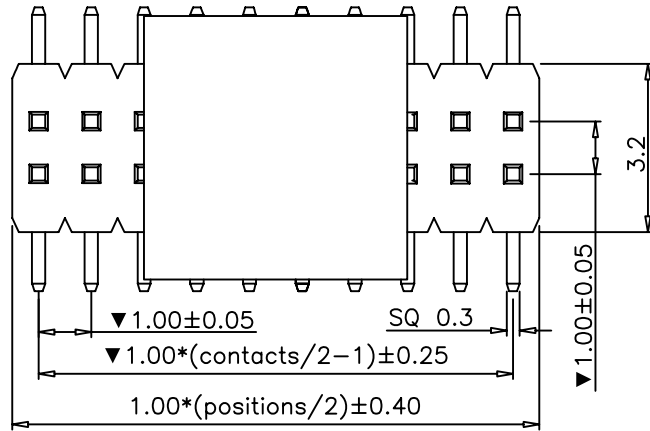
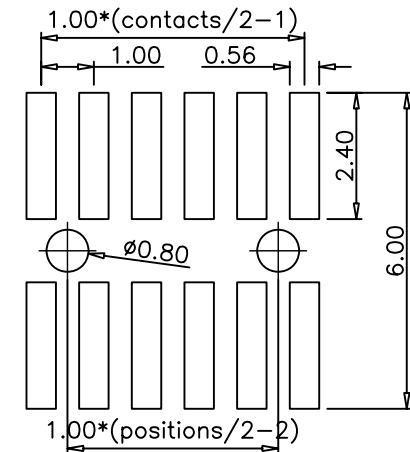

Specification

1. Material:

- 1.1 Contact: Phosphor bronze, selective plating
- 1.2 Insulator: PA6T, black, UL94V-0, RoHS

2. Electrical:

- 2.1 Current rating: 0.75Amps/contact max.
- 2.2 Contact resistance: ≤30mΩ/contact
- 2.3 Insulation resistance: ≥1000MΩ at V=100V
- 2.4 Withstanding Voltage: 500V AC/minute

3. Mechanical:

- 3.1 Retention force: 0.3Kg/contact min.
- 3.2 Operating temperature: -55°C to +105°C
- 3.3 Mate with FCA/B/D2 series

Ordering Information

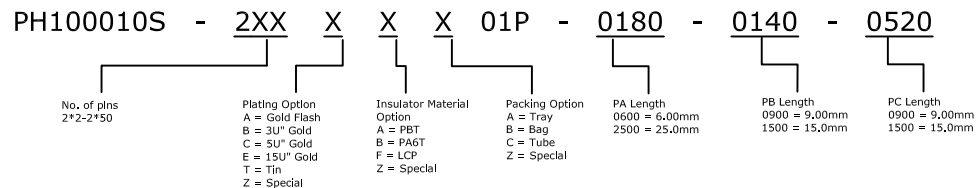

TM-LINK

TM-Link Technology Limited

TITLE: 1.0mm Pin Header Dual row SMT					
TOLERANCES UNLESS OTHERWISE SPECIFIED:	DRAWN	Robert	DATE: 2012-03-28	DRAWING NO.:	PH100010S-2XX-01P
X.XX ±0.25	CHECKED	Jhon	PROJECTION		
X.X ±0.35	APPROVED	Jack	SIZE: A4	UNIT: MM	SCALE: 1:1
X. ±0.50				SHEET: 1/1	REV: A