

RoHS  
compliant

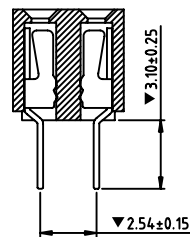
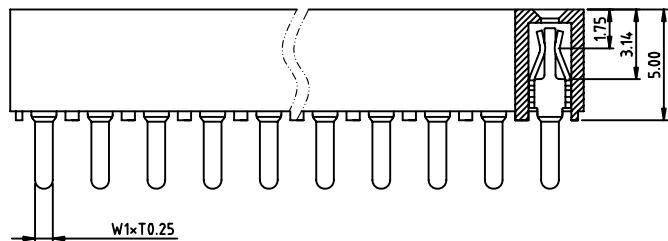
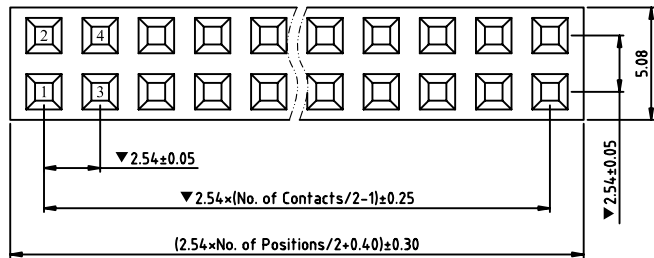

### SPECIFICATIONS

|                        |   |
|------------------------|---|
| Contact:               | phosphor bronze                         |
| Contact plating:       | see ordering information                |
| Insulator:             | black glass filled polyester<br>UL94V-0 |
| Current rating:        | 3.0Amps                                 |
| Contact resistance:    | 20mΩ max.                               |
| Insulation resistance: | 1000MΩ min. at 100V                     |
| Withstanding Voltage:  | 550V AC/minute                          |
| Operating temperature: | -55°C to +105°C                         |
| Soldering temperature: | 245°C ± 5° 5S                           |
| Critical Dimensions:   | ▼                                       |

### Recommended P.C.B Layout (±0.05)

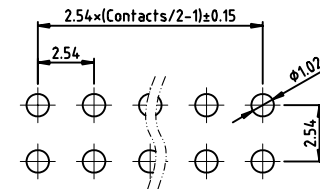

## Ordering Information

**FH254050D1U - 2XX X X X 01**

|                         |   |   |  |
|-------------------------|---|---|--|
| No. of pins<br>1*2-1*40 | Plating Option<br>A = Gold Flash<br>B = 30" Gold<br>C = 50" Gold<br>E = 150" Gold<br>T = Tin<br>Z = Special | Insulator Material<br>Option<br>A = PBT<br>B = PAGT<br>F = LCP<br>Z = Special | Packing Option<br>A = Tray<br>B = Bag<br>C = Tube<br>Z = Special |
|-------------------------|---|---|--|

# TM-LINK

TM-Link Technology Limited

|  |          |  |            |            |              |                    |  |
|--|----------|--|------------|------------|--------------|--------------------|--|
| TITLE:                                 |          | 2.54mm Female Header Dual row Dip type |            |            |              |                    |  |
| TOLERANCES UNLESS OTHERWISE SPECIFIED: | DRAWN    | Robert                                 | DATE:      | 2012-03-28 | DRAWING NO.: | FH254050D1U-2XX-01 |  |
| X.XX ±0.25                             | CHECKED  | Jhon                                   | PROJECTION |            |              |                    |  |
| X.X ±0.35                              | APPROVED | Jack                                   | SIZE:      | A4         | UNIT:        | MM                 |  |
| X. ±0.50                               |          |  | SCALE:     | 1:1        | SHEET:       | 1/1                |  |
|  |          |  |            |            | REV:         | A                  |  |